

Tax Parcel ID 17 007100010361

After recording, return to:
Georgia Power Company
Attn: Land Acquisition (Recording)
241 Ralph McGill Blvd NE
Bin 10151
Atlanta, GA 30308-3374

PROJECT 2023080195 LETTER FILE DEED FILE MAP FILE
ACCOUNT NUMBER 11069276-GPC9596-VBS-15
NAME OF LINE/PROJECT: PI# L8242 JOHNSON FERRY CORRIDOR IMPROVEMENTS COSS TS-191
(FULTON COUNTY) DL (2)

PARCEL NUMBER 010

STATE OF GEORGIA
FULTON COUNTY

DISTRIBUTION TREE TRIM/ CLEARING EASEMENT

For and in consideration of the sum of Ten and No/100 Dollars (\$10.00) and other good and valuable consideration, in hand paid by GEORGIA POWER COMPANY, a Georgia corporation (the "Company"), the receipt and sufficiency of which are hereby acknowledged, FULTON COUNTY (the "Undersigned", which term shall include heirs, successors and/or assigns), whose mailing Address is 141 Pryor St SW# 8021, Atlanta, GA 30303-3466, does hereby grant and convey to the Company, its successors and assigns, the right, privilege and easement to cut, trim, remove, clear and keep clear any and all trees and other obstructions located on the Easement Area (as defined below), as well as the right, privilege and easement to cut, trim and/or remove any trees which now or may hereafter endanger the electric transmission and/or distribution lines and/or communication lines of the Company, its successors and assigns now constructed or which may hereafter be constructed on or adjacent to the Property (as defined below) and the right of ingress and egress over the Property to and from the Easement Area in connection therewith.

The "Property" is defined as that certain tract of land owned by the Undersigned at MOUNT VERNON HWY, SANDY SPRINGS, GA 30328 (Tax Parcel ID No. 17 007100010361) in Land Lot 21 of the 17 District of Fulton County, Georgia.

The "Easement Area" is defined as the portion of the Property located within twenty (20) feet of the centerline of the existing overhead of the existing electric transmission, distribution and/or communication lines of the Company, such Easement area being more particularly shown on "Exhibit "B" attached hereto and made a part hereof.

[Signature(s) on Following Page(s)]

PARCEL 010

NAME OF
LINE/PROJECT:

PI# L8242 JOHNSON FERRY CORRIDOR IMPROVEMENTS
COSS TS-191 (FULTON COUNTY) DL (2)

Signed, sealed and delivered this
____ day of _____, 2024
in the presence of:

FULTON COUNTY, a political subdivision of
the State of Georgia

Witness

By: _____
Robert L. Pitts, Chairman
Fulton County Board of Commissioners

[Notarial Seal]

Attest: _____
Tonya R. Grier
Clerk to the Commission

APPROVED AS TO FORM

Y. Soo Jo, County Attorney

Exhibit "B"

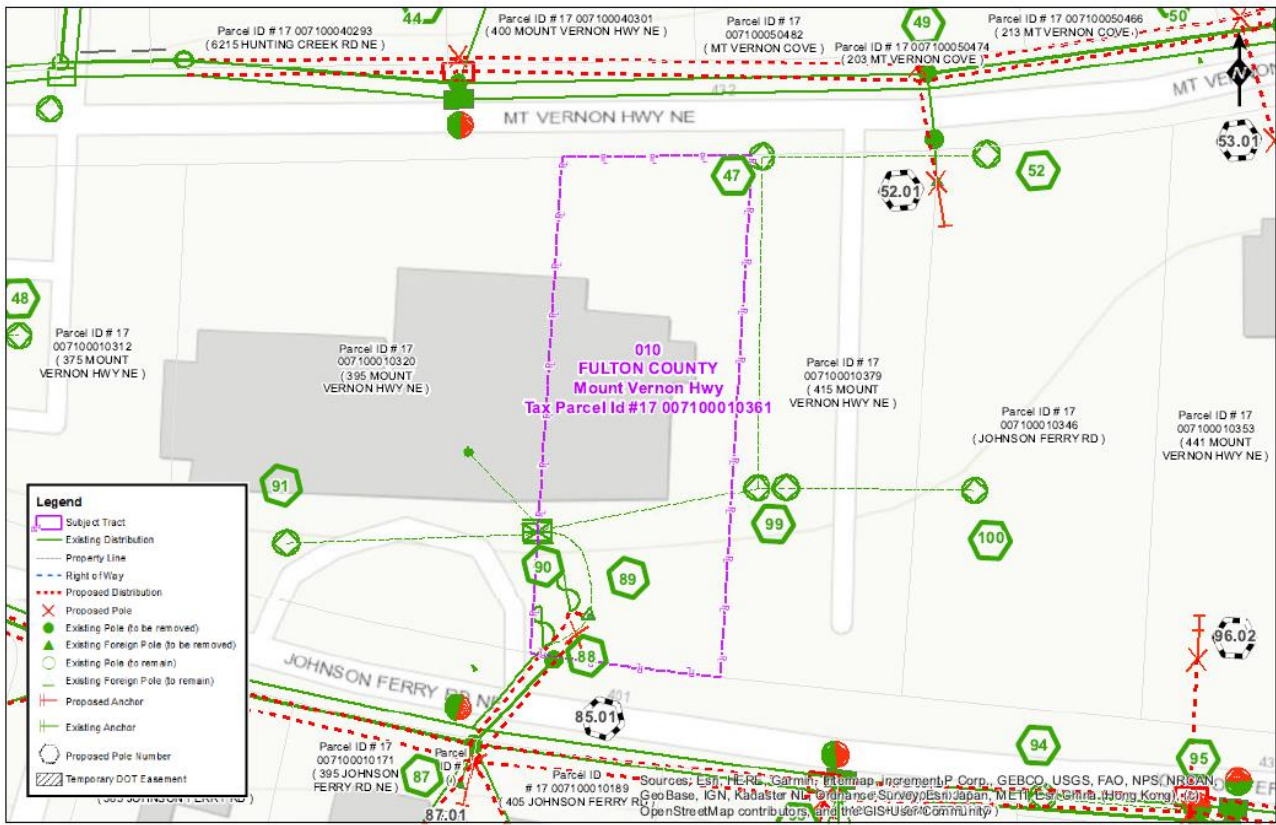

Georgia Power

Land Engineering
Prepare Date: 9/11/2023

Exhibit B
PARCEL 010

MAP N
Structure and line location
data and subject to change.

PI # L8242 JOHNSON FERRY CORRIDOR
IMPROVEMENTS COSS TS-191
(FULTON COUNTY)
DISTRIBUTION LINE
LIMS # 2023080195