



# Proposal

**Quote #:** Q-59075-1  
**Drawing Ver:** 328833 1H Eclipse  
 Touchpads GA State  
 Contract  
**Date:** 9/13/2023  
**Expires On:** 9/19/2023

**Per state of GA contract remit to:**  
 Spacesaver Storage Systems, Inc.  
 PO Box 603039  
 Charlotte, NC 28260-3039



**Install To**  
 Fulton County DA  
 5550 Fulton Industrial Blvd., Suite B  
 and 136 Pryor St  
 Atlanta, GA 30336 & 30303

**Bill To**  
 Fulton County  
 136 Pryor Street, S.W. 3rd Floor  
 Atlanta, 30303

SALESPERSON	EMAIL	DELIVERY METHOD	PAYMENT METHOD
Steve Goldsmith	sgoldsmith@pattersonpoppe.com		Deposit/Progress Payments

STATE OF GEORGIA CONTRACT NO: 99999-SPD-0000100-083  
 PEOPLE SOFT VENDOR NO: 0000097152  
 ORDER FROM: SPACESAVER STORAGE SYSTEMS, INC.  
 1450 JANESVILLE AVE  
 FORT ATKINSON, WI 53538  
 PLEASE ALSO EMAIL COPY OF ORDER TO: SGOLDSMITH@PATTERSONPOPE.COM FOR PROCESSING

Group Name	Description	Net Total
Spacesaver Material (On Contract)	Per attached drawings 328833 REV 1H <i>Located in Main Evidence Storage Facility</i>  Evidence Lockers with push button locking mechanism and pick-proof unlock Mobile System for long term evidence storage - Powered GA State Contract <i>In Courthouse</i>  Special Pass-Back Evidence lockers	\$227,548.89
Material Off Contract	Available to be purchased as buy-out commercial item on this state contract PO Roll-lock doors and pass-back mechanisms	\$9,785.59
Install & Delivery (Off Contract)	Shipping included on contract items this is freight on non-contract items, receipt and inspection, short term storage*, local/inside delivery and Factory Trained and certified installation services.  Please Note: Regular business hours, normal building conditions. The customer will be responsible for storage fees of \$2300, per month (estimated), incurred 30 days after the ship date that are related to a delay in an installation date due to the customer's request or a site related project delay.	\$83,538.20

Sub Total:	\$320,872.68
Estimated Total Tax:	
<b>Grand Total:</b>	<b>\$320,872.68</b>

### Important Proposal Notes

Terms Per Contract.

Any quoted installation labor price is based on information provided at time of request.

Inaccurate information or changes made after quote date may result in additional labor and equipment charges.



# Proposal

**Quote #:** Q-59075-1  
**Drawing Ver:** 328833 1H Eclipse  
 Touchpads GA State  
 Contract  
**Date:** 9/13/2023  
**Expires On:** 9/19/2023

Per state of GA contract remit to:  
 Spacesaver Storage Systems, Inc.  
 PO Box 603039  
 Charlotte, NC 28260-3039



**Drawings:** Final drawings must be approved by end user prior to job start up. Installation is to be done according to plans and specifications of approved drawings.

**Quote:** Is based on normal working hours: 8a.m. to 5p.m. (unless noted)

**Changes to scope of project at time of install:** All changes to plans or fabrication of material must be approved by salesperson or the installation supervisor. (Installers are not authorized to make changes or perform work outside of the approved scope)

**Electrical Work:** Any unforeseen electric work claimed back by the electricians shall be an additional work charge to client and is not the responsibility of Patterson Pope.

**Floor covering:** shall be the responsibility of the end user unless otherwise specified.

**Work Site:** Area free and clear of all obstacles prior to start of installation. Electricity available. Ample staging space required.

**Miscellaneous:** Additional costs may be incurred for downtime due to circumstances beyond our control.

**INFO REGARDING STORAGE FEES:** The customer acknowledges that they will be responsible for Storage Fees of \$50 per pallet, per month, incurred 30 days after the ship date that are related to a delay in an installation date due to a customer's request or a site related project delay

Must have a working elevator at time of unload or additional charges may incur for material handling of equipment up or down stairs.

Please indicate color choices on your PO.

**Signature:** \_\_\_\_\_

**Effective Date:** \_\_\_\_/\_\_\_\_/\_\_\_\_

**Name (Print):** \_\_\_\_\_

**Title:** \_\_\_\_\_

Please sign and email to Steve Goldsmith at [sgoldsmith@pattersonpoppe.com](mailto:sgoldsmith@pattersonpoppe.com).

THANK YOU FOR YOUR BUSINESS!

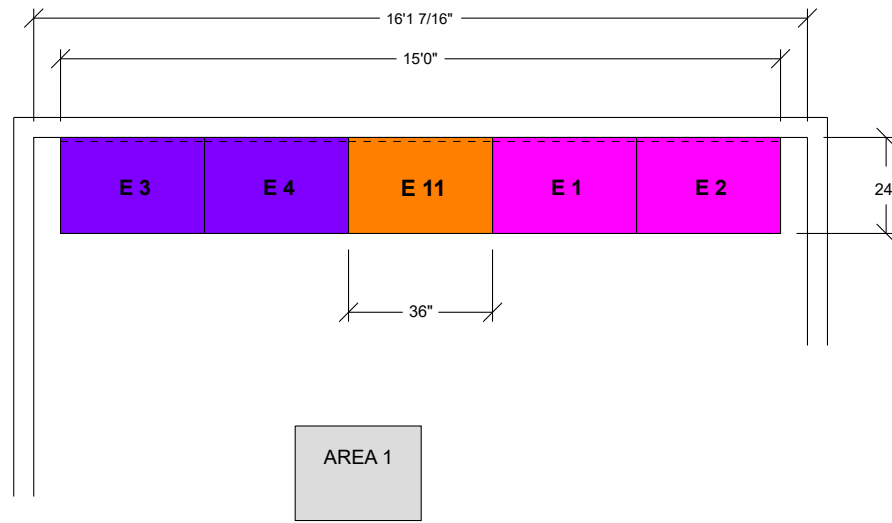

AREA 1

THIS AREA EVIDENCE LOCKERS TO BE  
NON PASS-THRU, STANDARD LOCKS

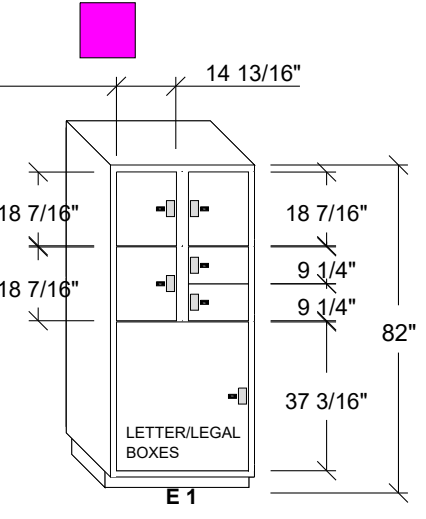
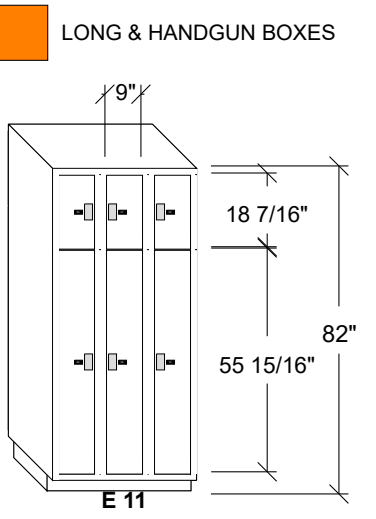
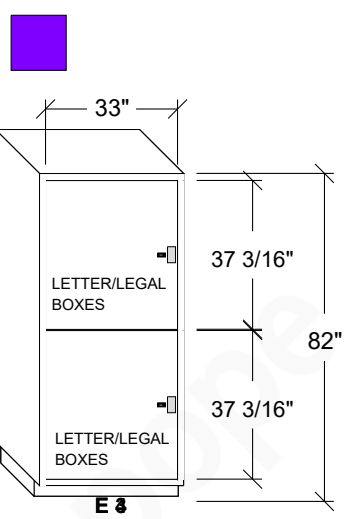

**CURRENT LEAD TIME FOR PRODUCT  
AS DRAWN IS 16 WEEKS FROM ORDER DATE  
LEAD TIMES SUBJECT TO CHANGE**



Project Name: <b>FULTON COUNTY DA EVIDENCE</b>  Salesperson: <b>GOLDSMITH, STEVE</b>	Scale <b>1/4" = 1'</b>	Rev level: <b>1H</b>	Project #: <b>328833</b>	APPROVAL This drawing Approved By: _____ Dated _____
			Drawn by: <b>R ESTRIDGE</b>	
			Date Printed: <b>09/05/2023</b>	



**HAND GUNS 2X8X13**  
 BOXES 4 WIDE, 3 DEEP, 8 HIGH PER LEVEL  
 (96)/LEVEL, (576)/ SECTION  
 4 SECTIONS = 2304 CAPACITY

**LONG GUN BOXES**  
 (1) 14"D, (1) 8"D, 4 HIGH PER LEVEL  
 (8)/LEVEL, (48)/ SECTION  
 11 SECTIONS = 528 CAPACITY

**LONG/HANDGUN GROWTH**

**HD BOX STORAGE SHELVING**  
 48"W X 12"D EACH SIDE  
 ~ (1008) BOX CAPACITY  
 STANDARD SIZE BANKER BOXES

**HEAVY DUTY GUN BOX SHELVING**  
 54"W X 24"D

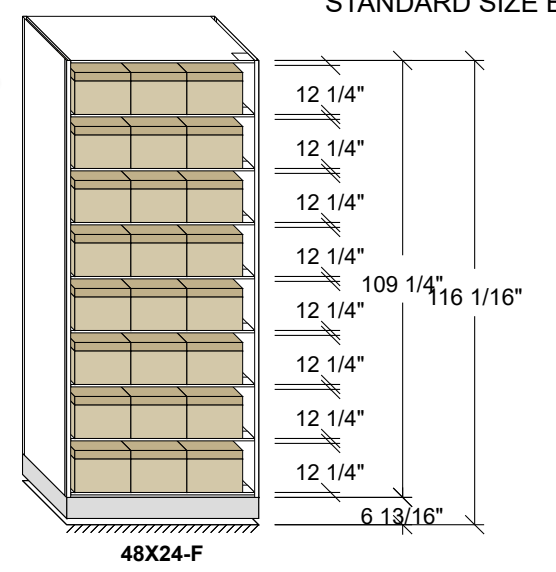
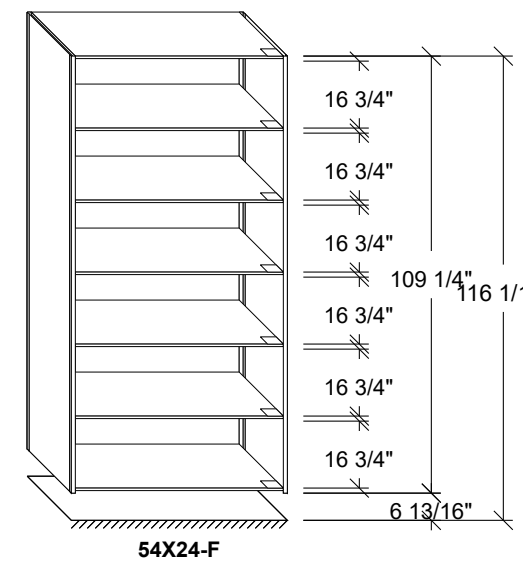

LOCKING TAMBOUR  
 DOORS THIS RANGE

AREA 2 MOBILE OPTION

**STANDARD SYSTEM CHARACTERISTICS**

GUIDANCE	DUAL FLANGE
RAIL TYPE	B ANTI-TIP
END PANELS	HIGH PRESSURE LAMINATE
DRIVE TYPE	LINE SHAFT ECLIPSE W/ TOUCHPADS
SWEEP	1 PHOTOSWEEP / AISLE
SAFETY	SINGLE ENTRY / MANUAL RESET
FLOOR/RAMP	STANDARD
STATIONARY UNITS	ON RAISED PLATFORMS
FLOOR COVERING	RUBBER MAT BY P2

**SHELVING CHARACTERISTICS**

TYPE	4-POST
UPRIGHTS	ALL CLOSED
DOUBLE UNITS	FULL DEPTH
UPRIGHT HEIGHT	109-1/4"
NO. OF OPENINGS	SEE ELEVATIONS
DIVIDERS PER OP.	NONE
FRONT BASE	NONE - MOBILE SUPPORT
SHELF TYPE	ALL HD PLAIN
SUPPORT TYPE	HD SUPPORTS
REF. SHELVES	NONE
BACK PANELS	NONE



Project Name: **FULTON COUNTY DA EVIDENCE**

Salesperson:  
**GOLDSMITH, STEVE**

Scale  
 1/4" = 1'

Rev level:  
 1H

Project #:  
 328833  
 Drawn by:  
**R ESTRIDGE**  
 Date Printed:  
 09/05/2023

APPROVAL  
 This drawing Approved By:  
 \_\_\_\_\_  
 Dated \_\_\_\_\_

THIS AREA EVIDENCE LOCKERS TO BE  
NON PASS-THRU, PASS-BACK,  
SHARED USE WITH DEADBOLT  
WITH DIGILOCK NUMERIS ASPIRE  
DAY USE LOCKS

AREA 6  
3RD FLOOR

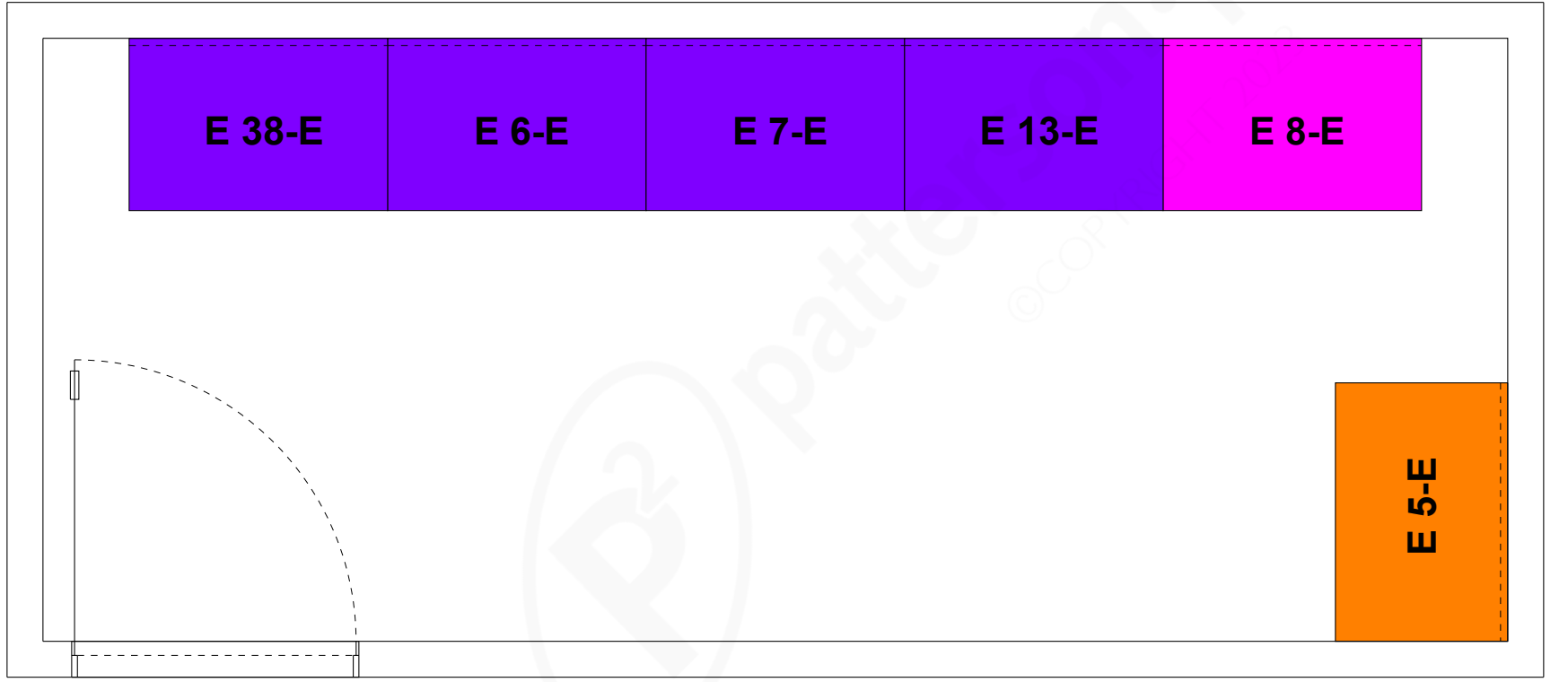

Project Name: FULTON COUNTY DA EVIDENCE

Salesperson:  
GOLDSMITH, STEVE

Scale  
1/2" = 1'

Rev level:  
1H

Project #:  
328833  
Drawn by:  
R ESTRIDGE  
Date Printed:  
09/05/2023

APPROVAL  
This drawing Approved By:  
\_\_\_\_\_  
Dated \_\_\_\_\_

THIS AREA EVIDENCE LOCKERS TO BE  
NON PASS-THRU, PASS-BACK,  
SHARED USE WITH DEADBOLT  
WITH DIGILOCK NUMERIS ASPIRE  
DAY USE LOCKS

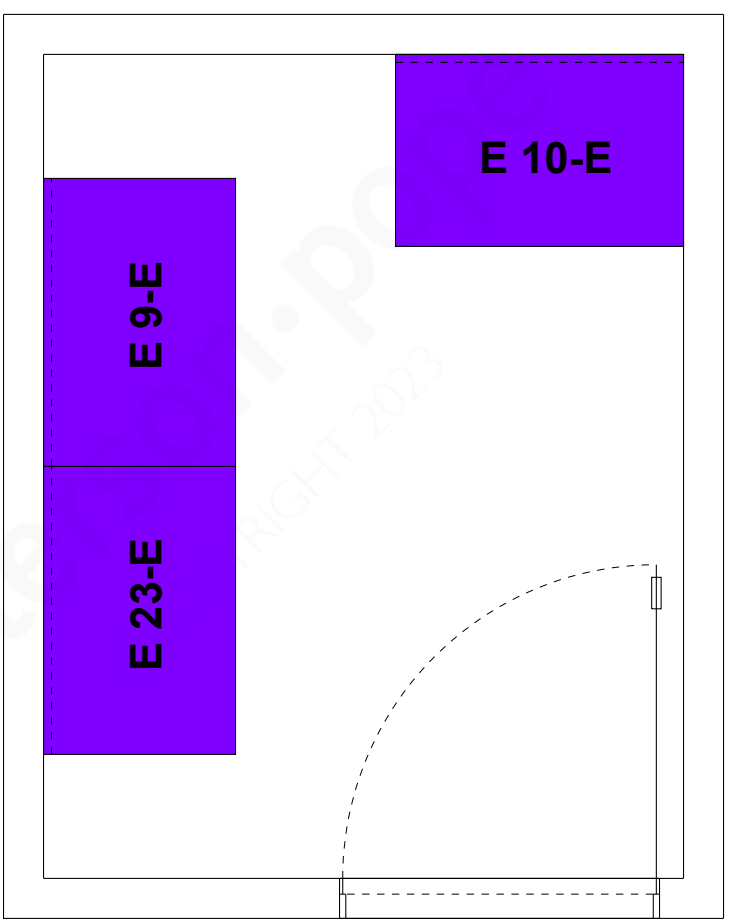

AREA 7  
EV-F

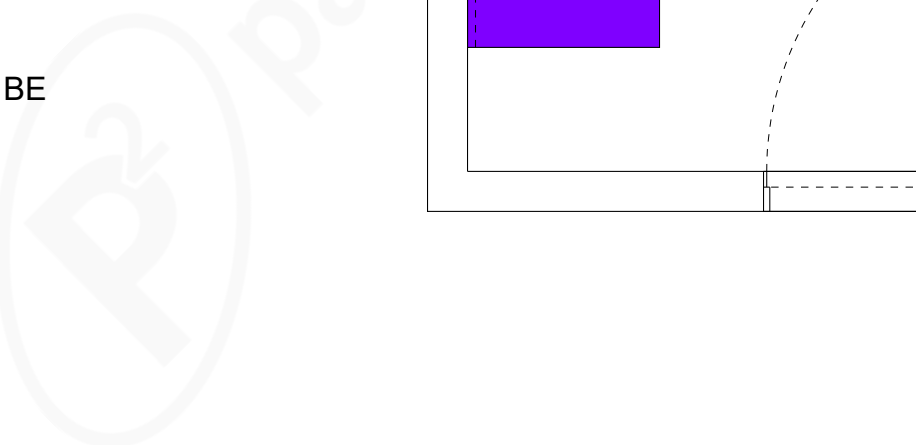

Project Name: FULTON COUNTY DA EVIDENCE		Project #: 328833	APPROVAL This drawing Approved By: _____ Dated _____
Salesperson: GOLDSMITH, STEVE		Drawn by: R ESTRIDGE	
Scale: 1/2" = 1'	Rev level: 1H	Date Printed: 09/05/2023	

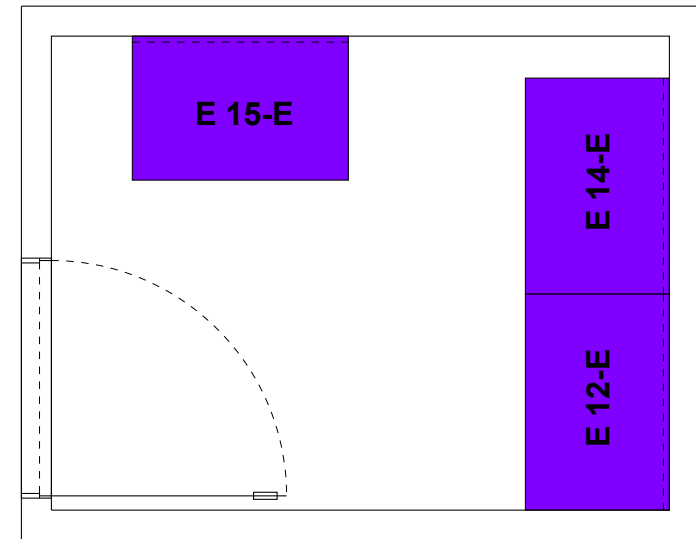

EV-9



THESE AREAS EVIDENCE LOCKERS TO BE  
NON PASS-THRU, PASS-BACK,  
SHARED USE WITH DEADBOLT  
WITH DIGILOCK NUMERIS ASPIRE  
DAY USE LOCKS

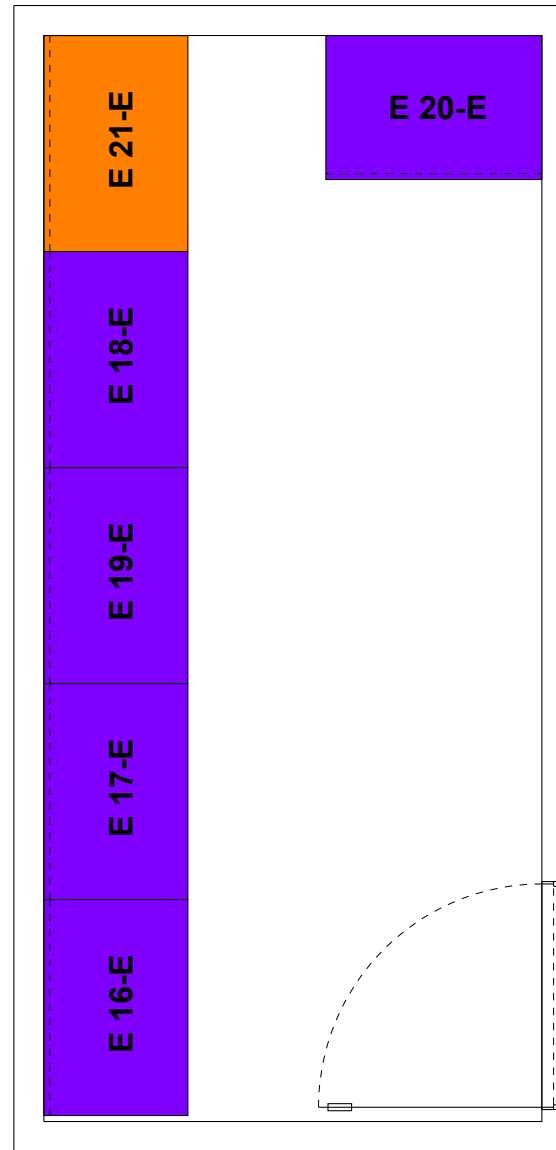

EV-E



Project Name: FULTON COUNTY DA EVIDENCE

Salesperson:  
GOLDSMITH, STEVE

Scale  
3/8" = 1'

Rev level:  
1H

Project #:  
328833  
Drawn by:  
R ESTRIDGE  
Date Printed:  
09/05/2023

APPROVAL  
This drawing Approved By:  
\_\_\_\_\_  
Dated \_\_\_\_\_